

## Datasheet - AZ 15/16-B1-2053

Safety switch with separate actuator / AZ 15 / Actuator



- For interlocking of light to medium-weight guards



(Minor differences between the printed image and the original product may exist!)

### Ordering details

|                          |                  |
|--------------------------|------------------|
| Product type description | AZ 15/16-B1-2053 |
| Article number           | 101111079        |
| EAN code                 | 4030661104300    |

### Global Properties

|              |                           |
|--------------|---------------------------|
| Product name | Gerader Betätiger B1-2053 |
| Weight       | 18.5 g                    |

### Mechanical data

|                          |                 |
|--------------------------|-----------------|
| Design of actuators      | straight, rigid |
| Minimum actuating radius | 150 mm          |

### notice

Minimum actuating radius on hinged guards 150 mm

The axis of the hinge should be 11 mm above the top edge of the safety switch and in the same plane

### Documents

**Mounting and wiring instructions** (de, en, fr, it, es, jp) 267 kB, 29.08.2006

Code: m\_z15p02

### Images

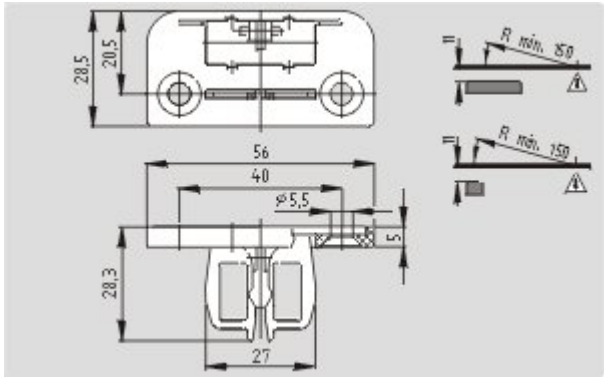

Dimensional drawing (actuator)

K.A. Schmersal GmbH & Co. KG, Möddinghofe 30, D-42279 Wuppertal  
 The data and values have been checked thoroughly. Technical modifications and errors excepted.  
 Generiert am 31.05.2013 - 11:39:44h Kasbase 2.2.17.F DBI

